

Stand-alone Belt-type Stepless Speed Changer



Speed Is Changed by Operating the Lever

Transmission capacity	0.2 kW to 2.2 kW
Speed change ratio	1:2 to 1:6
External pulley diameter	103 mm to 260 mm



Speed Changer with Lever

Speed can be changed quickly by changing the lever angle.

How to Place an Order



Specifications

Model		LA-100			LB-140			LB-160			LC-210			LC-260					
Belt in use		A belt x1			A belt x1			A belt x1			B belt x1			B belt x1			C belt x1		
Speed change ratio		1 : 2			1 : 4			1:4			1:2			1 : 4			1 : 2		
Transmission capacity [kW]		0.2			0.2 ~ 0.4			0.4 ~ 0.75			0.75			1.5 ~ 2.2					
Driven shaft rotation speed		Max. Intermediate Min.			Max. Intermediate Min.			Max. Intermediate Min.			Max. Intermediate Min.			Max. Intermediate Min.			Max. Intermediate Min.		
Transmission capacity [kW]	Motor pulley's external diameter [in.]																		
	2	0.18	0.18	0.18	0.18	0.18	0.18	0.18	0.18	0.18									
	2 1/2	0.3	0.3	0.26	0.3	0.3	0.18	0.3	0.3	0.18									
	3	0.38	0.38	0.3	0.37	0.37	0.22	0.37	0.37	0.22									
	3 1/2				0.45	0.67	0.26	0.52	0.67	0.26	0.52	0.52	0.52	0.52	0.52	0.45	0.52	0.52	0.52
	4				0.52	0.9	0.33	0.6	0.9	0.33	0.9	0.9	0.67	0.67	0.67	0.45	0.67	0.67	0.67
	4 1/2				0.6	1.05	0.33	0.67	1.12	0.33	1.05	1.05	0.75	0.97	1.05	0.45	1.05	1.05	0.75
	5							0.75	1.27	0.37	1.12	1.42	0.75	1.12	1.42	0.52	1.42	1.42	0.82
	5 1/2							0.82	1.35	0.41	1.27	1.57	0.9	1.2	1.8	0.6	1.8	1.8	0.9
6							0.9	1.42	0.45	1.35	1.65	0.9	1.27	2.25	0.67	1.95	2.25	0.97	
6 1/2													1.35	2.4	0.67	2.1	2.62	1.05	
7													1.5	2.47	0.75	2.25	3.0	1.12	
8																3.37	3.37	2.4	
																3.52	3.52	2.47	
Mass [kg]		3.9			7.6			15			21			37					

* The speed change ratio for the LK-110 (mass of 4 kg) with a transmission capacity of 0.1 kw using M belt is 1:5.

Dimensions

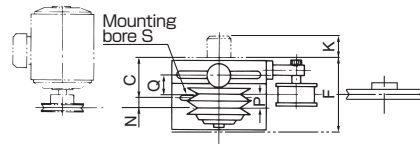
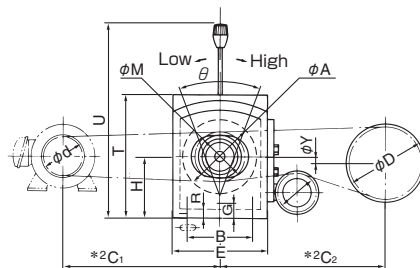

Model	A	B	C	E	F	G	H	N	P	Q	R	S	T	U	M	K	theta [°]
LK-110	116	105	58	165	125	24	105	29	23	25	18	11 x 30	200	327	80	24	32
LA-100	103	105	58	165	120	24	104	23	19	25	18	11 x 30	200	327	79	—	16
*1LB-140	140	120	75	185	140	27	118	19	25	42	20	11 x 28	235	356	98.5	—	33
*1LB-160	170	140	87	222	153	33	138	25	29	54	21	11 x 40	260	440	116 127	—	35 19
*1LC-210	212	155	104	262	191	42	162	20	37	67	28	14 x 56	290	472	142	—	39
*1LC-260	260	218	121	320	236	42	197	27	43	84	28	19 x 67	380	531	174 188	—	37 21

* Models indicated by *1 include a tension pulley (J= phi 70).
 * Calculate C₁ and C₂ indicated by *2 by reference to Items Checked for Design Purposes.
 * M: Medium pitch diameter