

SERVOFLEX SFF SS-B-B - Datasheet

SINGLE ELEMENT / CLAMPING TYPE

Specifications

Model	Rated torque [N·m]	Misalignment			Max. rotation speed [min ⁻¹]	Torsional stiffness [N·m/rad]	Axial stiffness [N/mm]	Moment of inertia [kg·m ²]	Mass [kg]
		Parallel [mm]	Angular [°]	Axial [mm]					
SFF-040SS-□ B-□ B-8N	8	0.02	1	± 0.2	18000	15000	174	0.03 × 10 ⁻³	0.17
SFF-040SS-□ B-□ B-12N	12	0.02	1	± 0.2	18000	15000	174	0.03 × 10 ⁻³	0.17
SFF-050SS-□ B-□ B-25N	25	0.02	1	± 0.3	18000	32000	145	0.10 × 10 ⁻³	0.36
SFF-060SS-□ B-□ B-60N	60	0.02	1	± 0.3	18000	104000	399	0.22 × 10 ⁻³	0.52
SFF-060SS-□ B-□ B-80N	80	0.02	1	± 0.3	18000	104000	399	0.23 × 10 ⁻³	0.49
SFF-070SS-□ B-□ B-90N	90	0.02	1	± 0.5	18000	240000	484	0.40 × 10 ⁻³	0.72
SFF-070SS-□ B-□ B-100N	100	0.02	1	± 0.5	18000	240000	484	0.42 × 10 ⁻³	0.67
SFF-080SS-□ B-□ B-150N	150	0.02	1	± 0.5	17000	120000	96	0.79 × 10 ⁻³	1.04
SFF-080SS-□ B-□ B-200N	200	0.02	1	± 0.5	17000	310000	546	1.25 × 10 ⁻³	1.40
SFF-090SS-□ B-□ B-250N	250	0.02	1	± 0.6	15000	520000	321	1.54 × 10 ⁻³	1.62
SFF-090SS-□ B-□ B-300N	300	0.02	1	± 0.6	15000	520000	321	1.58 × 10 ⁻³	1.53
SFF-100SS-□ B-□ B-450N	450	0.02	1	± 0.65	13000	740000	540	3.27 × 10 ⁻³	2.53
SFF-120SS-□ B-□ B-600N	600	0.02	1	± 0.8	11000	970000	360	6.90 × 10 ⁻³	3.78

- Higher rpm possible with balancing.
- Torsional stiffness values given are measured values for the flexible element alone.
- The moment of inertia and mass are specified for the maximum bore diameter.

Dimensions

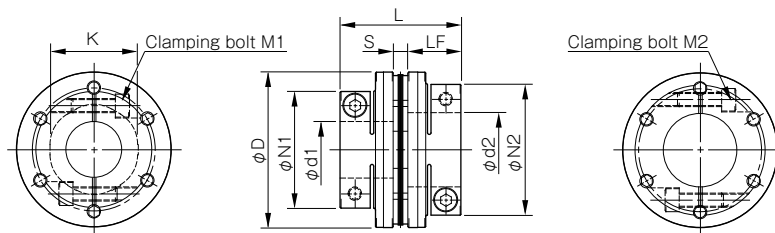

Model	d1 [mm]	d2 [mm]	D [mm]	L [mm]	N1 · N2 [mm]	LF [mm]	S [mm]	K [mm]	M1 · M2 Qty – Nominal dia.	M1 · M2 Tightening torque [N·m]		
SFF-040SS-□ B-□ B-8N	8 · 9 · 9.525	8 · 9 · 9.525 · 10 · 11 · 12 · 14 · 15 · 16	38	38.9	33	17.5	3.9	17	2-M4	3.4		
SFF-040SS-□ B-□ B-12N	10 · 11 · 12 · 14 · 15 · 16	10 · 11 · 12 · 14 · 15 · 16	38	38.9	33	17.5	3.9	17	2-M4	3.4		
SFF-050SS-□ B-□ B-25N	10 · 11 · 12 · 14 · 15 · 16 · 17 · 18 · 19	10 · 11 · 12 · 14 · 15 · 16 · 17 · 18 · 19	48	48.4	42	21.5	5.4	20	2-M5	7		
SFF-060SS-□ B-□ B-60N	12 · 14 · 15 · 16 · 17 · 18 · 19	12 · 14 · 15 · 16 · 17 · 18 · 19 · 20 · 22	58	53.4	44	24	5.4	32	2-M6	14		
	—	24 · 25 · 28			48				2-M5	7		
	—	30			52				—	—		
SFF-060SS-□ B-□ B-80N	20 · 22	20 · 22	58	53.4	44	24	5.4	32	2-M6	14		
	24 · 25 · 28	24 · 25 · 28			48				2-M5	7		
	30	30			52				—	—		
SFF-070SS-□ B-□ B-90N	18 · 19	18 · 19 · 20 · 22 · 24 · 25	68	55.9	47	25	5.9	38	2-M6	14		
	—	28 · 30 · 32 · 35			56						—	—
SFF-070SS-□ B-□ B-100N	20 · 22 · 24 · 25	20 · 22 · 24 · 25	68	55.9	47	25	5.9	38	2-M6	14		
	28 · 30 · 32 · 35	28 · 30 · 32 · 35			56						—	—
SFF-080SS-□ B-□ B-150N	22 · 24 · 25	22 · 24 · 25	78	68.3	53	30	8.3	37	2-M8	34		
	28 · 30 · 32 · 35	28 · 30 · 32 · 35			56				2-M6	14		
	—	—			53				—	—		
SFF-080SS-□ B-□ B-200N	28 · 30 · 32 · 35	28 · 30 · 32 · 35	78	67.7	70	30	7.7	42	2-M8	34		
	38	38			74						—	—
	—	—			—						—	—
SFF-090SS-□ B-□ B-250N	25 · 28	25 · 28 · 30 · 32	88	68.3	66	30	8.3	50	2-M8	34		
	—	35 · 38 · 40 · 42			74						—	—
SFF-090SS-□ B-□ B-300N	30 · 32	30 · 32	88	68.3	66	30	8.3	50	2-M8	34		
	35 · 38 · 40 · 42	35 · 38 · 40 · 42			74						—	—
SFF-100SS-□ B-□ B-450N	32 · 35 · 38 · 40 · 42 · 45 · 48	32 · 35 · 38 · 40 · 42 · 45 · 48	98	90.2	84	40	10.2	56	2-M10	68		
	32 · 35 · 38 · 40 · 42 · 45	32 · 35 · 38 · 40 · 42 · 45			84						—	—
SFF-120SS-□ B-□ B-600N	48 · 50 · 55	48 · 50 · 55	118	90.2	100	40	10.2	68	2-M10	68		

Standard Bore Dimensions

Model	Nominal diameter	Standard bore diameter d1 - d2 [mm]																											
		8	9	9.525	10	11	12	14	15	16	17	18	19	20	22	24	25	28	30	32	35	38	40	42	45	48	50	55	
SFF-040SS-□ B-□ B-8N	d1	●	●	●																									
	d2	●	●	●	●	●	●	●	●	●																			
SFF-040SS-□ B-□ B-12N	d1				●	●	●	●	●	●																			
	d2				●	●	●	●	●	●																			
SFF-050SS-□ B-□ B-25N	d1				●	●	●	●	●	●	●	●	●																
	d2				●	●	●	●	●	●	●	●	●	●															
SFF-060SS-□ B-□ B-60N	d1							●	●	●	●	●	●	●															
	d2							●	●	●	●	●	●	●	●	●	●	●	●	●	●	●	●	●	●	●	●	●	●
SFF-060SS-□ B-□ B-80N	d1														●	●	●	●	●	●	●	●	●	●	●	●	●	●	●
	d2														●	●	●	●	●	●	●	●	●	●	●	●	●	●	●
SFF-070SS-□ B-□ B-90N	d1																	●	●	●	●	●	●	●	●	●	●	●	●
	d2																	●	●	●	●	●	●	●	●	●	●	●	●
SFF-070SS-□ B-□ B-100N	d1																												
	d2																	●	●	●	●	●	●	●	●	●	●	●	●
SFF-080SS-□ B-□ B-150N	d1																												
	d2																	●	●	●	●	●	●	●	●	●	●	●	●
SFF-080SS-□ B-□ B-200N	d1																												
	d2																	●	●	●	●	●	●	●	●	●	●	●	●
SFF-090SS-□ B-□ B-250N	d1																												
	d2																	●	●	●	●	●	●	●	●	●	●	●	●
SFF-090SS-□ B-□ B-300N	d1																												
	d2																	●	●	●	●	●	●	●	●	●	●	●	●
SFF-100SS-□ B-□ B-450N	d1																												
	d2																	●	●	●	●	●	●	●	●	●	●	●	●
SFF-120SS-□ B-□ B-600N	d1																												
	d2																	●	●	●	●	●	●	●	●	●	●	●	●

How to Place an Order

SFF-080SS-25BK-30BK-200N

