

POSI-LOCK PSL-G - Datasheet

■ Dimensions

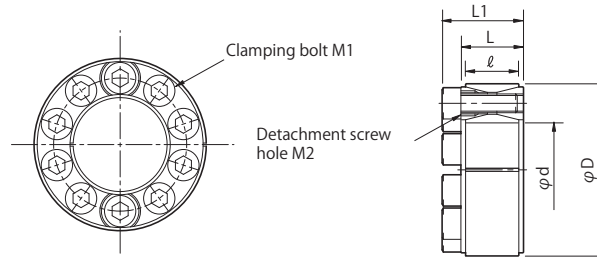

Unit [mm]

Model	d	D	L	ℓ	L1	M1	M2
PSL-G-19	19	47	20	17	26	8-M6 × 18	2-M8
PSL-G-20	20	47	20	17	26	8-M6 × 18	2-M8
PSL-G-22	22	47	20	17	26	8-M6 × 18	2-M8
PSL-G-24	24	50	20	17	26	8-M6 × 18	2-M8
PSL-G-25	25	50	20	17	26	8-M6 × 18	2-M8
PSL-G-28	28	55	20	17	26	10-M6 × 18	2-M8
PSL-G-30	30	55	20	17	26	10-M6 × 18	2-M8
PSL-G-32	32	60	20	17	26	12-M6 × 18	2-M8
PSL-G-35	35	60	20	17	26	12-M6 × 18	2-M8
PSL-G-38	38	65	20	17	26	14-M6 × 18	2-M8
PSL-G-40	40	65	20	17	26	14-M6 × 18	2-M8
PSL-G-42	42	75	24	20	32	12-M8 × 22	2-M10
PSL-G-45	45	75	24	20	32	12-M8 × 22	2-M10
PSL-G-48	48	80	24	20	32	12-M8 × 22	2-M10
PSL-G-50	50	80	24	20	32	12-M8 × 22	2-M10
PSL-G-55	55	85	24	20	32	14-M8 × 22	2-M10
PSL-G-60	60	90	24	20	32	14-M8 × 22	2-M10
PSL-G-65	65	95	24	20	32	16-M8 × 22	3-M10
PSL-G-70	70	110	28	24	38	14-M10 × 25	3-M12
PSL-G-75	75	115	28	24	38	14-M10 × 25	3-M12
PSL-G-80	80	120	28	24	38	14-M10 × 25	3-M12
PSL-G-85	85	125	28	24	38	16-M10 × 25	3-M12
PSL-G-90	90	130	28	24	38	16-M10 × 25	3-M12
PSL-G-95	95	135	28	24	38	18-M10 × 25	3-M12
PSL-G-100	100	145	33	26	45	14-M12 × 30	3-M14
PSL-G-110	110	155	33	26	45	14-M12 × 30	3-M14
PSL-G-120	120	165	33	26	45	16-M12 × 30	3-M14

* L and L1 are dimensions before the POSI-LOCK is mounted.

* The nominal diameter of each bolt and tap is equal to the quantity minus the nominal diameter of the screw threads times the nominal length.

* Screw hole M2 for removal purpose is indicated with a tool mark for sizes 19 to 60 and indicated by marking the head of the bolt with paint for sizes 65 or more.

■ Specifications

Model	Rated torque [N-m]	Rated thrust [N]	Shaft contact pressure [N/mm ²]	Hub contact pressure [N/mm ²]	Tightening torque [N-m]	Moment of inertia [kg·m ²]	Mass [kg]
PSL-G-19	289	30500	250	101	17	0.70 × 10 ⁻⁴	0.22
PSL-G-20	305	30500	238	101	17	0.70 × 10 ⁻⁴	0.21
PSL-G-22	335	30500	216	101	17	0.69 × 10 ⁻⁴	0.20
PSL-G-24	411	34300	223	107	17	0.89 × 10 ⁻⁴	0.23
PSL-G-25	428	34300	214	107	17	0.88 × 10 ⁻⁴	0.22
PSL-G-28	533	38100	212	108	17	1.28 × 10 ⁻⁴	0.26
PSL-G-30	571	38100	198	108	17	1.25 × 10 ⁻⁴	0.25
PSL-G-32	731	45700	223	119	17	1.80 × 10 ⁻⁴	0.30
PSL-G-35	800	45700	204	119	17	1.74 × 10 ⁻⁴	0.28
PSL-G-38	1020	53500	220	129	17	2.43 × 10 ⁻⁴	0.34
PSL-G-40	1070	53500	209	129	17	2.37 × 10 ⁻⁴	0.32
PSL-G-42	1680	80200	253	142	41	5.26 × 10 ⁻⁴	0.56
PSL-G-45	1800	80200	236	142	41	5.11 × 10 ⁻⁴	0.53
PSL-G-48	1920	80200	222	133	41	6.51 × 10 ⁻⁴	0.59
PSL-G-50	2010	80200	213	133	41	6.36 × 10 ⁻⁴	0.56
PSL-G-55	2570	93600	226	146	41	8.01 × 10 ⁻⁴	0.62
PSL-G-60	2810	93600	207	138	41	9.68 × 10 ⁻⁴	0.65
PSL-G-65	3090	95000	194	133	41	12.8 × 10 ⁻⁴	0.77
PSL-G-70	4800	137000	218	138	82	28.3 × 10 ⁻⁴	1.34
PSL-G-75	5160	138000	203	132	82	32.9 × 10 ⁻⁴	1.40
PSL-G-80	5510	138000	190	127	82	37.9 × 10 ⁻⁴	1.46
PSL-G-85	6500	153000	199	135	82	44.3 × 10 ⁻⁴	1.56
PSL-G-90	6880	153000	188	130	82	50.4 × 10 ⁻⁴	1.62
PSL-G-95	7940	167000	195	137	82	56.6 × 10 ⁻⁴	1.67
PSL-G-100	10100	202000	205	142	142	91.4 × 10 ⁻⁴	2.36
PSL-G-110	11100	202000	187	133	142	113.9 × 10 ⁻⁴	2.53
PSL-G-120	13500	225000	190	138	142	142.7 × 10 ⁻⁴	2.74

* The rated torque values are those when the thrust is zero and the rated thrust values are those when the torque is zero.

MECHANICAL SHAFT LOCK

POSI-LOCK PSL-G C - Datasheet

Electroless nickel coat type

■ Dimensions

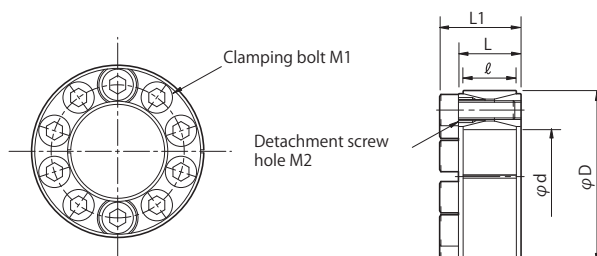

Unit [mm]

Model	d	D	L	ℓ	L1	M1	M2
PSL-G-19-C	19	47	20	17	26	8-M6 × 18	2-M8
PSL-G-20-C	20	47	20	17	26	8-M6 × 18	2-M8
PSL-G-22-C	22	47	20	17	26	8-M6 × 18	2-M8
PSL-G-24-C	24	50	20	17	26	8-M6 × 18	2-M8
PSL-G-25-C	25	50	20	17	26	8-M6 × 18	2-M8
PSL-G-28-C	28	55	20	17	26	10-M6 × 18	2-M8
PSL-G-30-C	30	55	20	17	26	10-M6 × 18	2-M8
PSL-G-32-C	32	60	20	17	26	12-M6 × 18	2-M8
PSL-G-35-C	35	60	20	17	26	12-M6 × 18	2-M8
PSL-G-38-C	38	65	20	17	26	14-M6 × 18	2-M8
PSL-G-40-C	40	65	20	17	26	14-M6 × 18	2-M8
PSL-G-42-C	42	75	24	20	32	12-M8 × 22	2-M10
PSL-G-45-C	45	75	24	20	32	12-M8 × 22	2-M10
PSL-G-48-C	48	80	24	20	32	12-M8 × 22	2-M10
PSL-G-50-C	50	80	24	20	32	12-M8 × 22	2-M10
PSL-G-55-C	55	85	24	20	32	14-M8 × 22	2-M10
PSL-G-60-C	60	90	24	20	32	14-M8 × 22	2-M10

* L and L1 are dimensions before the POSI-LOCK is mounted.

* The nominal diameter of each bolt and tap is equal to the quantity minus the nominal diameter of the screw threads times the nominal length.

■ Specifications

Model	Rated torque [N·m]	Rated thrust [N]	Shaft contact pressure [N/mm ²]	Hub contact pressure [N/mm ²]	Tightening torque [N·m]	Moment of inertia [kg·m ²]	Mass [kg]
PSL-G-19-C	289	30500	250	101	17	0.70×10^{-4}	0.22
PSL-G-20-C	305	30500	238	101	17	0.70×10^{-4}	0.21
PSL-G-22-C	335	30500	216	101	17	0.69×10^{-4}	0.20
PSL-G-24-C	411	34300	223	107	17	0.89×10^{-4}	0.23
PSL-G-25-C	428	34300	214	107	17	0.88×10^{-4}	0.22
PSL-G-28-C	533	38100	212	108	17	1.28×10^{-4}	0.26
PSL-G-30-C	571	38100	198	108	17	1.25×10^{-4}	0.25
PSL-G-32-C	731	45700	223	119	17	1.80×10^{-4}	0.30
PSL-G-35-C	800	45700	204	119	17	1.74×10^{-4}	0.28
PSL-G-38-C	1020	53500	220	129	17	2.43×10^{-4}	0.34
PSL-G-40-C	1070	53500	209	129	17	2.37×10^{-4}	0.32
PSL-G-42-C	1680	80200	253	142	41	5.26×10^{-4}	0.56
PSL-G-45-C	1800	80200	236	142	41	5.11×10^{-4}	0.53
PSL-G-48-C	1920	80200	222	133	41	6.51×10^{-4}	0.59
PSL-G-50-C	2010	80200	213	133	41	6.36×10^{-4}	0.56
PSL-G-55-C	2570	93600	226	146	41	8.01×10^{-4}	0.62
PSL-G-60-C	2810	93600	207	138	41	9.68×10^{-4}	0.65

* The rated torque values are those when the thrust is zero and the rated thrust values are those when the torque is zero.